

Day 1: Tuesday, October 1, 2024

Noon to 2:00 p.m.	Conference check-in	LaSells Stewart Center Lobby
1:00 to 1:15 p.m.	<i>Welcome from Community Partnership Program</i> Paul Bollinger, M.P.H. – Program Manager	Construction and Engineering Hall
1:15 to 1:30 p.m.	<i>Community Partnership Program Impact</i> Jackilen Shannon, Ph.D., and Kerri Winters-Stone, Ph.D. Co-Directors, Community Partnership Program	Construction and Engineering Hall
1:30 to 1:45 p.m.	<i>Welcome from Knight Cancer Institute</i> Brian Druker, M.D. – CEO, OHSU Knight Cancer Institute Thomas Sellers, Ph.D., M.P.H. – Director, OHSU Knight Cancer Institute	Construction and Engineering Hall
1:45 to 2:45 p.m.	<i>Braiding Together Evidence, Equity, and Advocacy for Cervical Cancer Prevention</i> Dr. Linda O. Eckert, M.D. Professor, Dept. of Obstetrics and Gynecology; Adjunct Professor, Dept. of Global Health, University of Washington	Construction and Engineering Hall
2:45 to 3 p.m.	Break	
3 to 4 p.m.	<i>Comprehensive Cancer Control Plan & Community Cancer Control Specialists</i> Jackilen Shannon, Ph.D. – Co-Director, Community Partnership Program Knight Cancer Institute Community Cancer Control Specialists: <ul style="list-style-type: none"> • Beth Dougherty, B.S. – Mid-Willamette • Blanca Flores, CHW – Gorge • Carina Garcia, B.A. – Eastern Oregon • Sarah Swanson, M.A., CCCE, SBD, CHW – South Coast 	Construction and Engineering Hall
4 to 4:15 p.m.	<i>Introductions to Posters</i> Blanca Cisneros, B.A. Community Outreach Specialist, OHSU Knight Cancer Institute	Construction and Engineering Hall
4:15 to 5:30 p.m.	<i>Poster Session</i>	Giustina Gallery
5:30 to 6 p.m.	<i>Speed Networking</i> Enjoy light appetizers and drinks while networking with your fellow attendees.	Giustina Gallery
6 to 7:30 p.m.	<i>Dinner</i> Enjoy dinner while building partnerships and connections.	Giustina Gallery

Have a good night!

Day 2: Wednesday, October 2, 2024

8 to 10 a.m.	Doors and conference check-in	LaSells Stewart Center Lobby
8 to 8:50 a.m.	Continental Breakfast	Giustina Gallery
8:50 to 9 a.m.	<i>Welcome from Community Partnership Program</i> Paul Bollinger, M.P.H. – Program Manager	Construction and Engineering Hall
9 to 10 a.m.	<i>What's possible with partnerships, a nurse journey.</i> Leda Isabel Garside, RN, BSN, MBA ¡Salud! Services Manager & Cultural Liaison, OHSU Hillsboro Medical Center	Construction and Engineering Hall
10 to 10:15 a.m.	Break	
10:15 to 10:45 a.m.	<i>Healthy Oregon Project</i> Jackilen Shannon, Ph.D. Co-Director, Community Partnership Program	Construction and Engineering Hall
11 to 11:45 a.m.	Lunch	Giustina Gallery
11:45 a.m. to 12:30 p.m.	<i>Group Photo</i>	Outside, weather permitting
12:30 to 1:30 p.m.	<i>Youth Are the Future, so What Are They Saying About HPV?</i> Facilitated by Paige Farris, MSW – Community Research Project Director, OHSU Knight Cancer Institute <ul style="list-style-type: none"> Celia Thomas – Health Educator, Sexual and Reproductive Health Program Public Health - Seattle & King County Sophie Wang – Co-Founder, Youth HPV Champions; senior at Beaverton Academy of Science and Engineering (BASE) Paloma Lee, Fern Page, Imogen Page – Youth Peer Educators, Public Health - Seattle & King County; seniors at Cleveland High School, Seattle 	Construction and Engineering Hall
1:30 to 2:30 p.m.	Breakout Sessions Session 1: Breaking Through the Noise: Utilizing social media to engage your audience Dustin Hawes – Senior Social Media Specialist, OHSU Knight Cancer Institute Session 2: From Surveys to Spreadsheets: Cleaning and Analyzing Survey Data Chelsea Ruder and Gina Beer, M.P.H. – Evaluation Research Data Analysts, OHSU Oregon Clinical and Translational Research Institute Session 3: Data Equity: Challenges and roadblocks in using existing data sources Wesley Stoller, M.A. – Data Analyst, OHSU Knight Cancer Institute	Session 1: Agriculture Science Room
		Session 2: Agriculture Leaders Room
		Session 3: Agriculture Production Room

2:30 to 2:45 p.m.	Break	
2:45 to 3:15 p.m.	<i>Preventing Cancer Through Health Literacy</i> Tillamook County Wellness Rochelle (Rockie) Phillips, RN, BSN – Public Health Deputy Director, Tillamook County Public Health Mareliza de Jesus – Project Coordinator, CARE Inc.	Construction and Engineering Hall
3:15 to 3:45 p.m.	<i>Use of self-collected HPV swabs for cervical cancer screening</i> La Clinica del Valle Family Health Care Center, Inc. Jamie Osborn, M.D. Population Health Officer and Family Physician, La Clinica	Construction and Engineering Hall
3:45 to 4 p.m.	<i>Closing Remarks</i> Jackilen Shannon, Ph.D., and Kerri Winters-Stone, Ph.D. Co-Directors, Community Partnership Program	Construction and Engineering Hall

Thank you for participating and safe travels!
Grantees, please complete the conference evaluation by October 16.

LaSells Stewart Center map:

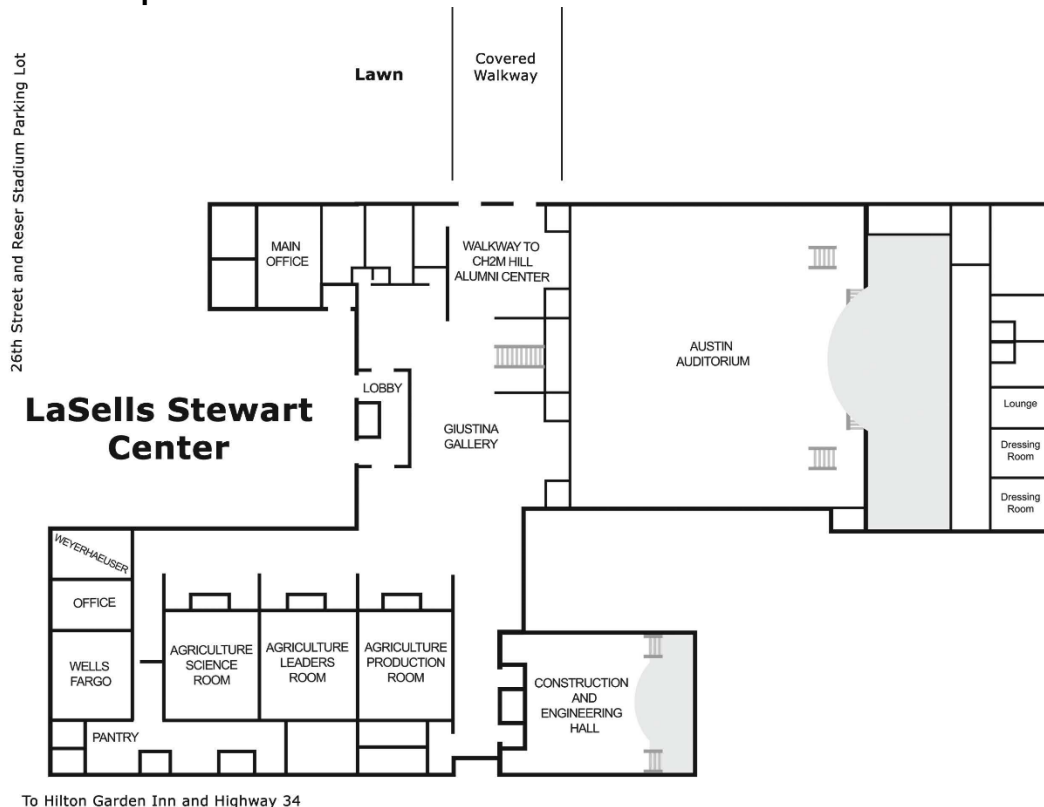

Poster Session

Tuesday, October 1, 4:15 to 5:30 p.m. in the Giustina Gallery

- 1. Adventist Health Columbia Gorge | Tier 1**
Family Caregiver Distress Identification Process
- 2. Adveuptist Health Portland | Tier 1**
East African Community Cancer Needs Assessment and Solutions
- 3. Silver Years| Tier 1**
Raising cancer awareness among immigrants and refugees from the former Soviet Union
- 4. Asante Physician Partners, General Surgery | Tier 1**
Overcoming Barriers to Care for Rural Esophageal Cancer Patients
- 5. Centro Cultural de Condado de Washington | Tier 1**
Rutas de Prevención del Cáncer (Route Toward Cancer Prevention)
- 6. Dermatology Health Specialists | Tier 1**
Breaking barriers: Bridging the gap in skin cancer care access for Central Oregon and surrounding rural communities
- 7. HIV Alliance | Tier 1**
Preventing and identifying HPV-related cancers among at-risk LGBTQIA+ and houseless populations in Lane County
- 8. Salem Free Clinics | Tier 1**
Increasing cancer screening for vulnerable populations, especially among low-income, uninsured, or underinsured women
- 9. Togo Community Organization of Oregon | Tier 1**
Education on Cancer Symptoms, Risk Factors and Early Detection
- 10. Independent Living Resources | Tier 2**
Assessment and Education Reducing Disability Disparities in Cancer Screening and Prevention
- 11. Malheur County Health Department | Tier 2**
Improve HPV Uptake among Malheur County Adolescents (ages 13-17)
- 12. Urban League of Portland | Tier 3**
Conquering Cancer Campaign (Educating the Community for Change)